

Open

Licensing Sub Committee

Agenda

10.30am
Wednesday, 17th June 2020
To be held remotley



Licensing Sub Committee

Members of Committee:

Chairman: Councillor P Dyke
Councillor I Hardiman

Councillor L Whitehouse

Information for Members of the Public:

If you have any questions regarding the agenda or the attached papers please do not hesitate to contact the officer named below.

The meeting is open to the public except for any exempt/confidential items. These items are normally discussed at the end of the meeting. Where a meeting is held remotely, "open" means available for live or subsequent viewing.

Members of the public will be able to hear and see the meetings by a live stream on the Council's website: <https://www.wyreforestdc.gov.uk/streaming.aspx>

This meeting is being held remotely online and will be recorded for play back. You should be aware that the Council is a Data Controller under the Data Protection Act 2018. All streamed footage is the copyright of Wyre Forest District Council.

Part I of the Agenda includes items for discussion in public. You have the right to request to inspect copies of Minutes and reports on this Agenda as well as the background documents used in the preparation of these reports.

Part II of the Agenda (if applicable) deals with items of "Exempt Information" for which it is anticipated that the public may be excluded from the meeting and neither reports nor background papers are open to public inspection.

Declaration of Interests by Members – interests of members in contracts and other matters

Declarations of Interest are a standard item on every Council and Committee agenda and each Member must provide a full record of their interests in the Public Register.

In addition, alongside the Register of Interest, the Members Code of Conduct ("the Code") requires the Declaration of Interests at meetings. Members have to decide first whether or not they have a disclosable interest in the matter under discussion.

Please see the Members' Code of Conduct as set out in Section 14 of this constitution for full details.

Disclosable Pecuniary Interest (DPI) / Other Disclosable Interest (ODI)

DPI's and ODI's are interests defined in the Code of Conduct that has been adopted by the District.

If you have a DPI (as defined in the Code) in a matter being considered at a meeting of the Council (as defined in the Code), the Council's Standing Orders require you to leave the room where the meeting is held, for the duration of any discussion or voting on that matter.

If you have an ODI (as defined in the Code) you will need to consider whether you need to leave the room during the consideration of the matter.

For further information:

If you have any queries about this Agenda or require any details of background papers, further documents or information you should contact Sian Burford, Assistant Committee Services Officer, Wyre Forest House, Finepoint Way, Kidderminster, DY11 7WF. Telephone: 01562 732766 or email sian.burford@wyreforestdc.gov.uk

Wyre Forest District Council

Licensing Sub Committee

Wednesday, 17th June 2020

To be held remotley

Part 1

Open to the press and public

Agenda item	Subject	Page Number
1.	Apologies for Absence	
2.	Appointment of Substitute Members To receive the name of any Councillor who is to act as a substitute, together with the name of the Councillor for whom he/she is acting.	
3.	Declarations of Interests by Members In accordance with the Code of Conduct, to invite Members to declare the existence and nature of any Disclosable Pecuniary Interests (DPI's) and / or Other Disclosable Interests (ODI's) in the following agenda items and indicate the action that they will be taking when the item is considered. Please see the Members' Code of Conduct as set out in Section 14 of the Council's Constitution for full details.	
4.	Application for the Variation of a Premises Licence To receive a report from the Head of Worcestershire Regulatory Services which asks the Committee to consider and determine a variation of a premises licence in respect of The Black Star, 1 Mitton Street, Stourport-On-Severn, Worcestershire, DY13 8YP	5

WYRE FOREST DISTRICT COUNCIL

LICENSING SUB-COMMITTEE

17TH JUNE 2020

LICENSING ACT 2003

APPLICATION FOR VARIATION OF A PREMISES LICENCE

THE BLACK STAR

PUBLIC HEARING	
Director:	Head of Worcestershire Regulatory Services
Contact Officer:	Emma Rhodes Technical Officer (Licensing) 01562 822799 enquiries@worcsregservices.gov.uk
Ward(s) affected:	MITWWF
Appendices:	Appendix 1 – Application Form Appendix 2 – Existing Licence Appendix 3 – Representations from other parties

1. PURPOSE OF REPORT

- 1.1 To consider and determine an application for variation of the premises licence in respect of the premises below:

**The Black Star
1 Mitton Street
Stourport-On-Severn
Worcestershire
DY13 8YP**

A copy of the application is attached at “**Appendix 1**”.

- 1.2 A copy of the existing licence is attached at “**Appendix 2**”.

2. BACKGROUND

2.1 On 28 April 2020 an application was received from Paul Neades of The Licensing Guys on behalf of premises licence holders Maria & Andrew Gooding for variation of the premises licence issued in respect of:

The Black Star
 1 Mitton Street
 Stourport-On-Severn
 Worcestershire
 DY13 8YP

2.2 The application contained all the requisite documentation including the fee.

2.3 It can be confirmed that the application has been advertised in accordance with the requirements of the Licensing Act 2003 and associated regulations and that the application has also been served on all responsible authorities.

2.4 The applicant is applying for the following variations to their existing licence:

- Extend the opening hours of the premises to 10:00 - 00:00 Sunday to Thursday and 10:00 - 01:00 Friday to Saturday.
- Vary the timings for the sale of alcohol, late night refreshment, playing of recorded music and performance of live music.
- Addition of conditions relating the four licensing objectives
- Vary non-standard timings

2.5 The applicant is applying for the following licensable activities and timings:

Activity	Days	From	To	Indoors/Out doors
Late Night Refreshment	Friday to Saturday	23:00	01:00	Indoors
Late Night Refreshment	Sunday to Thursday	23:00	00:00	Indoors
Playing of Recorded Music	Friday to Saturday	10:00	01:00	Indoors
Playing of Recorded Music	Sunday to Thursday	10:00	00:00	Indoors
Performance of Live Music	Friday to Saturday	10:00	01:00	Both
Performance of Live Music	Sunday to Thursday	10:00	00:00	Both
Sale of Alcohol	Friday to Saturday	10:00	01:00	
Sale of Alcohol	Sunday to Thursday	10:00	00:00	

2.6 In addition to the above the applicant has applied for the following, to extend the hours of non-standard timings to:

- Every Friday, Saturday, Sunday and Monday of Bank Holiday weekends, Christmas Eve and Boxing Day until 01:00

- New Year's Eve from 10:00 until terminal hour on New Year's Day.

2.7 In an effort to remove any ambiguity and following liaison with the Licensing Office the applicant has removed the following non standard timings from the application form:

- It is permitted to show 12 live sporting events per year by visual display, with hours predicated by the timings of that live sporting event. However:
(a) At least 14 days' notice of the event(s) shall be given to the Police and the Licensing Authority, and
(b) The event meets the approval of the Licensing Authority. Where no comment is made, then the notification is automatically approved after 7 days.

And replaced with the following

- The premises may open to the public and provide the licensable activity of the sale by retail of alcohol between 05:00 and 10:00 on any day when there is a relevant, televised, international cricket, football or rugby match where the match is scheduled to begin between the hours of 05:00 and 10:00. A relevant televised international cricket, football or rugby match is a match where the match is being broadcast live and where one of the following teams is participating in the match: England, Wales, Scotland, Northern Ireland, Republic of Ireland or any team that is representative of these nations (e.g. The British and Irish Lions).

2.8 A number of additional conditions have also been included on the application, with a view to promoting the four licensing objectives, these can be seen at "**Appendix 1**". In particular Members should note the following conditions:

- Any outdoors Live Music Event shall conclude by 21:00hrs
- Any outdoors alcohol sales shall cease by 23:00hrs.

3. REPRESENTATIONS

Responsible Authorities

3.1 All of the responsible authorities have been consulted directly and during the consultation period no representations were received from any of the responsible authorities in relation to this application

Other Persons

3.2 Six representations have been received from other persons. The representations make mention of concerns linked to the licensing objective of prevention of public nuisance. Copies of the representations can be seen at "**Appendix 3**".

4. LOCAL POLICY CONSIDERATIONS

4.1 The Sub-Committee should have regard to the Council's Statement of Licensing Policy under the Licensing Act 2003.

4.2 The Council's Statement of Licensing Policy is available to download from the Council's website or to request a hard copy, contact Worcestershire Regulatory Services on 01905 822799 or email enquiries@worcsregservices.gov.uk

4.3 The Sub-Committee's attention should be drawn to the following **Paragraphs 5.3 - 5.6** of the Council's Statement of Licensing Policy in respect of this application generally:

(5.3) The licensing authority will aim to carry out its licensing functions in a way that promotes tourism, increases leisure and culture provision and encourages economic development within the District.

(5.4) However the licensing authority will also always try and balance the needs of the wider community, local community and commercial premises, against the needs of those whose quality of life may be adversely affected by the carrying on of licensable activities, particularly within residential areas.

(5.5) In particular the licensing authority will attempt to control any potential negative impacts from the carrying on of licensable activities, such as increased crime and disorder, anti-social behaviour, noise, nuisance, risks to public safety and harm to children.

(5.6) The licensing authority's aim is to facilitate well run and managed premises with licence holders displaying sensitivity to the impact of the premises on local residents."

5. LICENSING OBJECTIVES

5.1 The representations received objecting to the grant of the variation application raise concerns about the prevention of "Public Nuisance" licensing objective.

Public Nuisance

5.2 **Paragraph 2.15** of the s182 Guidance (April 2018) states:

"The 2003 Act enables licensing authorities and responsible authorities, through representations, to consider what constitutes public nuisance and what is appropriate to prevent it in terms of conditions attached to specific premises licences and club premises certificates. It is therefore important that in considering the promotion of this licensing objective, licensing authorities and responsible authorities focus on the effect of the licensable activities at the specific premises on

persons living and working (including those carrying on business) in the area around the premises which may be disproportionate and unreasonable. The issues will mainly concern noise nuisance, light pollution, noxious smells and litter.”

5.3 In addition to **Paragraph 2.15** of the s182 Guidance referred to above and the subsequent paragraphs of that section, the Sub-Committee’s attention is also drawn to **Paragraphs 6.24 - 6.29** of the Council’s Statement of Licensing Policy relating to the Prevention of Public Nuisance in respect of this application.

5.4 The Sub-Committee’s attention is further drawn to **Paragraph 8** of the Council’s Statement of Licensing Policy relating to Licensing Hours. The Sub-Committee will see, at Paragraph 8.3, that:

“Consideration may be taken to imposing stricter restrictions on licensing hours when it is appropriate to control noise and disturbance from particular licensed premises, such as those in mainly residential areas”,

6. LEGAL IMPLICATIONS

6.1 The Sub-Committee is obliged to determine each application on its own merits and with a view to the promotion of the licensing objectives which are:

- the prevention of crime and disorder;
- public safety;
- the prevention of public nuisance;
- the protection of children from harm.

6.2 In making its decision, the Sub-Committee is also obliged to have regard to the guidance issued by the Secretary of State under section 182 of the Licensing Act 2003 and the Council’s own Statement of Licensing Policy.

6.3 The Sub-Committee must also have regard to the representations made and the evidence it hears.

6.4 The Sub-Committee must take such of the following steps as it considers appropriate for the promotion of the licensing objectives:

- (a) Grant the application as requested
- (b) Modify the conditions of the licence, by altering or omitting or adding to them.
- (c) Reject the application in whole or in part.

- 6.5 The Sub-Committee is asked to note that it may not modify the conditions or reject the whole or part of the application merely because it considers it desirable to do so. It must actually be appropriate in order to promote the licensing objectives.
- 6.6 All parties to the hearing will be notified of the Sub-Committee's decision in writing within five working days of the conclusion of the hearing.
- 6.7 Any party aggrieved by a decision taken by the Sub-Committee may appeal against the decision to a Magistrates' Court within 21 days of being notified of the decision in writing.
- 6.8 The hearing should be conducted in accordance with the agreed procedure.
- 7. FOR DECISION**
- 7.1 The Sub-Committee must consider and determine the application.



Wyre Forest
Application to vary a premises licence
Licensing Act 2003

For help contact
enquiries@worcsregservices.gov.uk
 Telephone: 01905 822799

* required information

Section 1 of 18

You can save the form at any time and resume it later. You do not need to be logged in when you resume.

System reference This is the unique reference for this application generated by the system.

Your reference You can put what you want here to help you track applications if you make lots of them. It is passed to the authority.

Are you an agent acting on behalf of the applicant?

- Yes No

Put "no" if you are applying on your own behalf or on behalf of a business you own or work for.

Applicant Details

* First name

* Family name

* E-mail

Main telephone number Include country code.

Other telephone number

Indicate here if the applicant would prefer not to be contacted by telephone

Is the applicant:

- Applying as a business or organisation, including as a sole trader
 Applying as an individual

A sole trader is a business owned by one person without any special legal structure. Applying as an individual means the applicant is applying so the applicant can be employed, or for some other personal reason, such as following a hobby.

Applicant Business

Is the applicant's business registered in the UK with Companies House? Yes No

Is the applicant's business registered outside the UK? Yes No

Note: completing the Applicant Business section is optional in this form.

Business name If the applicant's business is registered, use its registered name.

VAT number Put "none" if the applicant is not registered for VAT.

Continued from previous page...

Legal status

Applicant's position in the business

Home country

The country where the applicant's headquarters are.

Applicant Business Address

If the applicant has one, this should be the applicant's official address - that is an address required of the applicant by law for receiving communications.

Building number or name

Street

District

City or town

County or administrative area

Postcode

Country

Agent Details

* First name

* Family name

* E-mail

Main telephone number

Include country code.

Other telephone number

Indicate here if you would prefer not to be contacted by telephone

Are you:

- An agent that is a business or organisation, including a sole trader
- A private individual acting as an agent

A sole trader is a business owned by one person without any special legal structure.

Agent Business

Is your business registered in the UK with Companies House? Yes No

Note: completing the Applicant Business section is optional in this form.

Is your business registered outside the UK? Yes No

Business name

If your business is registered, use its registered name.

VAT number

Put "none" if you are not registered for VAT.

Legal status

Continued from previous page...

Your position in the business

Home country

The country where the headquarters of your business is located.

Agent Business Address

If you have one, this should be your official address - that is an address required of you by law for receiving communications.

Building number or name

Street

District

City or town

County or administrative area

Postcode

Country

Section 2 of 18

APPLICATION DETAILS

This application cannot be used to vary the licence so as to extend the period for which the licence has effect or to vary substantially the premises to which it relates. If you wish to make that type of change to the premises licence, you should make a new premises licence application under section 17 of the Licensing Act 2003.

I/we, as named in section 1, being the premises licence holder, apply to vary a premises licence under section 34 of the Licensing Act 2003 for the premises described in section 2 below.

* Premises Licence Number

Are you able to provide a postal address, OS map reference or description of the premises?

- Address OS map reference Description

Postal Address Of Premises

Building number or name

Street

District

City or town

County or administrative area

Postcode

Country

Premises Contact Details

Telephone number

Continued from previous page...

Non-domestic rateable value of premises (£)

19,500

Section 3 of 18

VARIATION

Do you want the proposed variation to have effect as soon as possible? Yes No

Do you want the proposed variation to have effect in relation to the introduction of the late night levy?

Yes No

You do not have to pay a fee if the only purpose of the variation for which you are applying is to avoid becoming liable to the late night levy.

If your proposed variation would mean that 5,000 or more people are expected to attend the premises at any one time, state the number expected to attend

Describe Briefly The Nature Of The Proposed Variation

Describe the premises. For example the type of premises, its general situation and layout and any other information which could be relevant to the licensing objectives. Where your application includes off-supplies of alcohol and you intend to provide a place for consumption of these off-supplies, you must include a description of where the place will be and its proximity to the premises.

This well-established and successful business would like to add additional hours, additional facility in the garden to allow for live music in the early part of the evening, with amended conditions to promote the licensing objectives to reflect those extended hours/activity. They also seek the ability to host the viewing of occasional live sporting events (e.g. The Rugby World Cup) which occur outside normal operating hours without recourse to submitting a raft of Temporary Event Notices.

Section 4 of 18

PROVISION OF PLAYS

See guidance on regulated entertainment

Will the schedule to provide plays be subject to change if this application to vary is successful?

Yes No

Section 5 of 18

PROVISION OF FILMS

See guidance on regulated entertainment

Will the schedule to provide films be subject to change if this application to vary is successful?

Yes No

Section 6 of 18

PROVISION OF INDOOR SPORTING EVENTS

Continued from previous page...

See guidance on regulated entertainment

Will the schedule to provide indoor sporting events be subject to change if this application to vary is successful?

- Yes No

Section 7 of 18

PROVISION OF BOXING OR WRESTLING ENTERTAINMENTS

See guidance on regulated entertainment

Will the schedule to provide boxing or wrestling entertainments be subject to change if this application to vary is successful?

- Yes No

Section 8 of 18

PROVISION OF LIVE MUSIC

See guidance on regulated entertainment

Will the schedule to provide live music be subject to change if this application to vary is successful?

- Yes No

Standard Days And Timings

MONDAY

Start

End

Start

End

Provide timings in 24 hour clock (e.g., 16:00) and only give details for the days of the week when you intend the premises to be used for the activity.

TUESDAY

Start

End

Start

End

WEDNESDAY

Start

End

Start

End

THURSDAY

Start

End

Start

End

FRIDAY

Start

End

Start

End

SATURDAY

Start

End

Start

End

Continued from previous page...

SUNDAY

Start	<input type="text" value="10:00"/>	End	<input type="text" value="00:00"/>
Start	<input type="text"/>	End	<input type="text"/>

Will the performance of live music take place indoors or outdoors or both? Where taking place in a building or other structure select as appropriate. Indoors may include a tent.

Indoors
 Outdoors
 Both

State type of activity to be authorised, if not already stated, and give relevant further details, for example (but not exclusively) whether or not music will be amplified or unamplified.

Although this request a variation only slightly extends the timings, it also extends Live Music to Outdoors i.e. the garden. However this is mitigated by the additional condition that there will be no outdoors performance of music after 21:00hrs.

State any seasonal variations for the performance of live music

For example (but not exclusively) where the activity will occur on additional days during the summer months.

Non-standard timings. Where the premises will be used for the performance of live music at different times from those listed, above below.

For example (but not exclusively), where you wish the activity to go on longer on a particular day e.g. Christmas Eve.

Every Friday, Saturday, Sunday & Monday of Bank Holiday weekends, Christmas Eve and Boxing Day until 01:00hrs.
 New Year's Eve: 10:00hrs until terminal hour on New Year's Day.

Section 9 of 18

PROVISION OF RECORDED MUSIC

See guidance on regulated entertainment

Will the schedule to provide recorded music be subject to change if this application to vary is successful?

Yes
 No

Standard Days And Timings

MONDAY

Start	<input type="text" value="10:00"/>	End	<input type="text" value="00:00"/>
Start	<input type="text"/>	End	<input type="text"/>

Provide timings in 24 hour clock (e.g., 16:00) and only give details for the days of the week when you intend the premises to be used for the activity.

TUESDAY

Start	<input type="text" value="10:00"/>	End	<input type="text" value="00:00"/>
Start	<input type="text"/>	End	<input type="text"/>

Continued from previous page...

WEDNESDAY

Start End

Start End

THURSDAY

Start End

Start End

FRIDAY

Start End

Start End

SATURDAY

Start End

Start End

SUNDAY

Start End

Start End

Will the playing of recorded music take place indoors or outdoors or both?

- Indoors Outdoors Both

Where taking place in a building or other structure select as appropriate. Indoors may include a tent.

State type of activity to be authorised, if not already stated, and give relevant further details, for example (but not exclusively) whether or not music will be amplified or unamplified.

State any seasonal variations for playing recorded music.

For example (but not exclusively) where the activity will occur on additional days during the summer months.

Non-standard timings. Where the premises will be used for the playing of recorded music at different times from those listed above, list below.

For example (but not exclusively), where you wish the activity to go on longer on a particular day e.g. Christmas Eve.

Every Friday, Saturday, Sunday & Monday of Bank Holiday weekends, Christmas Eve and Boxing Day until 01:00hrs.
New Year's Eve: 10:00hrs until terminal hour on New Year's Day.

Continued from previous page...

Section 10 of 18

PROVISION OF PERFORMANCES OF DANCE

See guidance on regulated entertainment

Will the schedule to provide performances of dance be subject to change if this application to vary is successful?

Yes No

Section 11 of 18

PROVISION OF ANYTHING OF A SIMILAR DESCRIPTION TO LIVE MUSIC, RECORDED MUSIC OR PERFORMANCES OF DANCE

See guidance on regulated entertainment

Will the schedule to provide anything similar to live music, recorded music or performances of dance be subject to change if this application to vary is successful?

Yes No

Section 12 of 18

PROVISION OF LATE NIGHT REFRESHMENT

Will the schedule to provide late night refreshment be subject to change if this application to vary is successful?

Yes No

Standard Days And Timings

MONDAY	Start <input type="text" value="23:00"/>	End <input type="text" value="00:00"/>	Provide timings in 24 hour clock (e.g., 16:00) and only give details for the days of the week when you intend the premises to be used for the activity.
	Start <input type="text"/>	End <input type="text"/>	
TUESDAY	Start <input type="text" value="23:00"/>	End <input type="text" value="00:00"/>	
	Start <input type="text"/>	End <input type="text"/>	
WEDNESDAY	Start <input type="text" value="23:00"/>	End <input type="text" value="00:00"/>	
	Start <input type="text"/>	End <input type="text"/>	
THURSDAY	Start <input type="text" value="23:00"/>	End <input type="text" value="00:00"/>	
	Start <input type="text"/>	End <input type="text"/>	
FRIDAY	Start <input type="text" value="23:00"/>	End <input type="text" value="01:00"/>	
	Start <input type="text"/>	End <input type="text"/>	

Continued from previous page...

SATURDAY

Start End

Start End

SUNDAY

Start End

Start End

Will the provision of late night refreshment take place indoors or outdoors or both?

- Indoors
 Outdoors
 Both

Where taking place in a building or other structure select as appropriate. Indoors may include a tent.

State type of activity to be authorised, if not already stated, and give relevant further details, for example (but not exclusively) whether or not music will be amplified or unamplified.

State any seasonal variations.

For example (but not exclusively) where the activity will occur on additional days during the summer months.

Non standard timings. Where the premises will be used for the provision of late night refreshment at different times from those listed above, list below.

For example (but not exclusively), where you wish the activity to go on longer on a particular day e.g. Christmas Eve.

Every Friday, Saturday, Sunday & Monday of Bank Holiday weekends, Christmas Eve and Boxing Day until 01:00hrs.
 New Year's Eve: 23:00hrs until terminal hour on New Year's Day.

It is permitted to show 12 live sporting events per year by visual display, with hours predicated by the timings of that live sporting event.

However:

- (a) At least 14 days' notice of the event(s) shall be given to the Police and the Licensing Authority, and
- (b) The event meets the approval of the Licensing Authority. Where no comment is made, then the notification is automatically approved after 7 days.

Section 13 of 18

SUPPLY OF ALCOHOL

Will the schedule to supply alcohol be subject to change if this application to vary is successful?

- Yes
 No

Continued from previous page...

Standard Days And Timings

MONDAY

Start

End

Start

End

Provide timings in 24 hour clock (e.g., 16:00) and only give details for the days of the week when you intend the premises to be used for the activity.

TUESDAY

Start

End

Start

End

WEDNESDAY

Start

End

Start

End

THURSDAY

Start

End

Start

End

FRIDAY

Start

End

Start

End

SATURDAY

Start

End

Start

End

SUNDAY

Start

End

Start

End

Will the sale of alcohol be for consumption?

- On the premises Off the premises Both

If the sale of alcohol is for consumption on the premises select on, if the sale of alcohol is for consumption away from the premises select off. If the sale of alcohol is for consumption on the premises and away from the premises select both.

State any seasonal variations.

For example (but not exclusively) where the activity will occur on additional days during the summer months.

Continued from previous page...

Non-standard timings. Where the premises will be used for the supply of alcohol at different times from those listed above, list below.

For example (but not exclusively), where you wish the activity to go on longer on a particular day e.g. Christmas Eve.

Every Friday, Saturday, Sunday & Monday of Bank Holiday weekends, Christmas Eve and Boxing Day until 01:00hrs.
New Year's Eve: 10:00hrs until terminal hour on New Year's Day.

It is permitted to show 12 live sporting events per year by visual display, with hours predicated by the timings of that live sporting event.

However:

- (a) At least 14 days' notice of the event(s) shall be given to the Police and the Licensing Authority, and
- (b) The event meets the approval of the Licensing Authority. Where no comment is made, then the notification is automatically approved after 7 days.

Section 14 of 18

ADULT ENTERTAINMENT

Highlight any adult entertainment or services, activities, or other entertainment or matters ancillary to the use of the premises that may give rise to concern in respect of children.

Provide information about anything intended to occur at the premises or ancillary to the use of the premises which may give rise to concern in respect of children, regardless of whether you intend children to have access to the premises, for example (but not exclusively) nudity or semi-nudity, films for restricted age groups etc gambling machines etc.

n/a

Section 15 of 18

HOURS PREMISES ARE OPEN TO THE PUBLIC

Standard Days And Timings

MONDAY

Start

End

Start

End

Provide timings in 24 hour clock (e.g., 16:00) and only give details for the days of the week when you intend the premises to be used for the activity.

TUESDAY

Start

End

Start

End

WEDNESDAY

Start

End

Start

End

THURSDAY

Start

End

Start

End

Continued from previous page...

FRIDAY

Start	<input type="text" value="10:00"/>	End	<input type="text" value="01:00"/>
Start	<input type="text"/>	End	<input type="text"/>

SATURDAY

Start	<input type="text" value="10:00"/>	End	<input type="text" value="01:00"/>
Start	<input type="text"/>	End	<input type="text"/>

SUNDAY

Start	<input type="text" value="10:00"/>	End	<input type="text" value="00:00"/>
Start	<input type="text"/>	End	<input type="text"/>

State any seasonal variations.

For example (but not exclusively) where the activity will occur on additional days during the summer months.

Non standard timings. Where you intend to use the premises to be open to the members and guests at different times from those listed above, list below.

For example (but not exclusively), where you wish the activity to go on longer on a particular day e.g. Christmas Eve.

Every Friday, Saturday, Sunday & Monday of Bank Holiday weekends, Christmas Eve and Boxing Day until 01:00hrs.
New Year's Eve: 10:00hrs until terminal hour on New Year's Day.

It is permitted to show 12 live sporting events per year by visual display, with hours predicated by the timings of that live sporting event.

However:

- (a) At least 14 days' notice of the event(s) shall be given to the Police and the Licensing Authority, and
- (b) The event meets the approval of the Licensing Authority. Where no comment is made, then the notification is automatically approved after 7 days.

Identify those conditions currently imposed on the licence which you believe could be removed as a consequence of the proposed variation you are seeking.

- I have enclosed the premises licence
- I have enclosed the relevant part of the premises licence

Continued from previous page...

Reasons why I have failed to enclose the premises licence or relevant part of premises licence.

[Empty box for reasons why failed to enclose licence]

Section 16 of 18

LICENSING OBJECTIVES

Describe the steps you intend to take to promote the four licensing objectives:

a) General – all four licensing objectives (b,c,d,e)

List here steps you will take to promote all four licensing objectives together.

The Black Star is a popular, well-established, well-run and respected premises which was awarded the Wyre Forest CAMRA Branch Pub of the Year 2020. The current management have run this pub successfully for many years, so successfully in fact that they have bought the premises from the Wye Valley Brewery. It possesses exemplary levels of favorable reviews on both Facebook and Trip Advisor, and continues to prove an asset to the local community.

Although currently closed through the COVID-19 pandemic, the owners have taken this opportunity to revisit their Premises Licence with a view to extend their operating hours and extend the functionality of their beer garden. They also seek the ability to host the viewing of occasional live sporting events (e.g. The Rugby World Cup) which occur outside normal operating hours without recourse to submitting a raft of Temporary Event Notices.

To safeguard the local amenity value, they are offering a comprehensive set of additional conditions to further promote the licensing objectives as a consequence.

b) The prevention of crime and disorder

As per pre-existing Licence, plus:

The Premises Licence Holder or DPS, or a person nominated by them in writing for the purpose, will employ SIA doorstaff on a risk assessed basis. The risk assessment shall be in writing and shall be made immediately available on request to an 'authorised person' (as defined by Section 13 of the Licensing Act 2003) or the Police.

c) Public safety

As per pre-existing Licence, plus:

The DPS and all other staff shall ensure that no open glassware or bottles are taken off the premises by customers.

d) The prevention of public nuisance

As per pre-existing Licence, plus:

Any Outdoors Live Music event shall conclude by 21:00hrs.

Any Outdoors Bar shall cease serving by 23:00hrs.

The Premises Licence Holder or DPS must immediately comply with any request to adjust noise levels/ frequency spectra made by an 'authorised person' (as defined by Section 13 of the Licensing Act 2003) or the Police.

e) The protection of children from harm

Continued from previous page...

As per pre-existing Licence, plus:

All bar staff engaged in the sale of alcohol to be trained in Responsible Alcohol Retailing to the minimum standard of Level 1 or any other similar training within one month of the date that this condition appears on this licence. Training records shall be kept on the premises and shall be produced to the police or an 'authorised person' (as defined by Section 13 of the Licensing Act 2003) or an authorised Trading Standards Officer of Worcestershire Council on reasonable request.

The premises shall operate a Challenge 25 Policy. Such policy shall be written down and kept at the premises. The policy shall be produced on demand of an authorised person' (as defined by Section 13 of the Licensing Act 2003) or the police or an authorised Trading Standards Officer of Worcestershire Council.

Prominent, clear and legible signage (in not less than 32 font bold) shall also be displayed at all entrances to the premises as well as at, at least one location behind any bar advertising the scheme operated.

A written register of refusals will be kept including a description of the people who have been unable to provide required identification to prove their age. Such records shall be kept for a period of 12 months and will be collected on a daily basis by the Designated Premises Supervisor and produced to the police or an 'authorised person' (as defined by Section 13 of the Licensing Act 2003) or an authorised Trading Standards Officer of Worcestershire Council on demand.

Section 17 of 18

NOTES ON REGULATED ENTERTAINMENT

Continued from previous page...

In terms of specific **regulated entertainments** please note that:

- Plays: no licence is required for performances between 08:00 and 23.00 on any day, provided that the audience does not exceed 500.
- Films: no licence is required for 'not-for-profit' film exhibition held in community premises between 08.00 and 23.00 on any day provided that the audience does not exceed 500 and the organiser (a) gets consent to the screening from a person who is responsible for the premises; and (b) ensures that each such screening abides by age classification ratings.
- Indoor sporting events: no licence is required for performances between 08.00 and 23.00 on any day, provided that the audience does not exceed 1000.
- Boxing or Wrestling Entertainment: no licence is required for a contest, exhibition or display of Greco-Roman wrestling, or freestyle wrestling between 08.00 and 23.00 on any day, provided that the audience does not exceed 1000. Combined fighting sports – defined as a contest, exhibition or display which combines boxing or wrestling with one or more martial arts – are licensable as a boxing or wrestling entertainment rather than an indoor sporting event.
- Live music: no licence permission is required for:
 - o a performance of unamplified live music between 08.00 and 23.00 on any day, on any premises.
 - o a performance of amplified live music between 08.00 and 23.00 on any day on premises authorised to sell alcohol for consumption on those premises, provided that the audience does not exceed 500.
 - o a performance of amplified live music between 08.00 and 23.00 on any day, in a workplace that is not licensed to sell alcohol on those premises, provided that the audience does not exceed 500.
 - o a performance of amplified live music between 08.00 and 23.00 on any day, in a church hall, village hall, community hall, or other similar community premises, that is not licensed by a premises licence to sell alcohol, provided that (a) the audience does not exceed 500, and (b) the organiser gets consent for the performance from a person who is responsible for the premises.
 - o a performance of amplified live music between 08.00 and 23.00 on any day, at the non-residential premises of (i) a local authority, or (ii) a school, or (iii) a hospital, provided that (a) the audience does not exceed 500, and (b) the organiser gets consent for the performance on the relevant premises from: (i) the local authority concerned, or (ii) the school or (iii) the health care provider for the hospital.
- Recorded Music: no licence permission is required for:
 - o any playing of recorded music between 08.00 and 23.00 on any day on premises authorised to sell alcohol for consumption on those premises, provided that the audience does not exceed 500.
 - o any playing of recorded music between 08.00 and 23.00 on any day, in a church hall, village hall, community hall, or other similar community premises, that is not licensed by a premises licence to sell alcohol, provided that (a) the audience does not exceed 500, and (b) the organiser gets consent for the performance from a person who is responsible for the premises.
 - o any playing of recorded music between 08.00 and 23.00 on any day, at the non-residential premises of (i) a local authority, or (ii) a school, or (iii) a hospital, provided that (a) the audience does not exceed 500, and (b) the organiser gets consent for the performance on the relevant premises from: (i) the local authority concerned, or (ii) the school proprietor or (iii) the health care provider for the hospital.

Continued from previous page...

- Dance: no licence is required for performances between 08.00 and 23.00 on any day, provided that the audience does not exceed 500. However, a performance which amounts to adult entertainment remains licensable.
- Cross activity exemptions: no licence is required between 08.00 and 23.00 on any day, with no limit on audience size for:
 - o any entertainment taking place on the premises of the local authority where the entertainment is provided by or on behalf of the local authority;
 - o any entertainment taking place on the hospital premises of the health care provider where the entertainment is provided by or on behalf of the health care provider;
 - o any entertainment taking place on the premises of the school where the entertainment is provided by or on behalf of the school proprietor; and
 - o any entertainment (excluding films and a boxing or wrestling entertainment) taking place at a travelling circus, provided that (a) it takes place within a moveable structure that accommodates the audience, and (b) that the travelling circus has not been located on the same site for more than 28 consecutive days.

Section 18 of 18

PAYMENT DETAILS

This fee must be paid to the authority. If you complete the application online, you must pay it by debit or credit card.

Variation Fees are determined by the non domestic rateable value of the premises.

To find out a premises non domestic rateable value go to the Valuation Office Agency site at http://www.voa.gov.uk/business_rates/index.htm

Band A - No RV to £4300	£100.00
Band B - £4301 to £33000	£190.00
Band C - £33001 to £8700	£315.00
Band D - £87001 to £12500	£450.00*
Band E - £125001 and over	£635.00*

*If the premises rateable value is in Bands D or E and the premises is primarily used for the consumption of alcohol on the premises then your are required to pay a higher fee

Band D - £87001 to £12500	£900.00
Band E - £125001 and over	£1,905.00

If you own a large premise you are subject to additional fees based upon the number in attendance at any one time

Capacity 5000-9999	£1,000.00
Capacity 10000 -14999	£2,000.00
Capacity 15000-19999	£4,000.00
Capacity 20000-29999	£8,000.00
Capacity 30000-39000	£16,000.00
Capacity 40000-49999	£24,000.00
Capacity 50000-59999	£32,000.00
Capacity 60000-69999	£40,000.00
Capacity 70000-79999	£48,000.00
Capacity 80000-89999	£56,000.00
Capacity 90000 and over	£64,000.00

* Fee amount (£)

DECLARATION

I/we understand it is an offence, liable on conviction to a fine up to level 5 on the standard scale, under section 158 of the

Continued from previous page...

* licensing act 2003, to make a false statement in or in connection with this application.

Ticking this box indicates you have read and understood the above declaration

This section should be completed by the applicant, unless you answered "Yes" to the question "Are you an agent acting on behalf of the applicant?"

* Full name

* Capacity

* Date / /
dd mm yyyy

Add another signatory

Once you're finished you need to do the following:

1. Save this form to your computer by clicking file/save as...
2. Go back to <https://www.gov.uk/apply-for-a-licence/premises-licence/wyre-forest/change-1> to upload this file and continue with your application.

Don't forget to make sure you have all your supporting documentation to hand.

IT IS AN OFFENCE, UNDER SECTION 158 OF THE LICENSING ACT 2003, TO MAKE A FALSE STATEMENT IN OR IN CONNECTION WITH THIS APPLICATION. THOSE WHO MAKE A FALSE STATEMENT MAY BE LIABLE ON SUMMARY CONVICTION TO A FINE OF ANY AMOUNT.

OFFICE USE ONLY

Applicant reference number	<input type="text" value="33-20"/>
Fee paid	<input type="text"/>
Payment provider reference	<input type="text"/>
ELMS Payment Reference	<input type="text"/>
Payment status	<input type="text"/>
Payment authorisation code	<input type="text"/>
Payment authorisation date	<input type="text"/>
Date and time submitted	<input type="text"/>
Approval deadline	<input type="text"/>
Error message	<input type="text"/>
Is Digitally signed	<input type="checkbox"/>



The Black Star 1 Mitton Street Stourport-on-Severn Worcestershire DY138YP

Scale 1:100

- Key**
-  Co2 Fire Extinguisher
 -  Foam Fire Extinguisher
 -  Licensable Activity
 -  Consumption Area
 -  CCTV

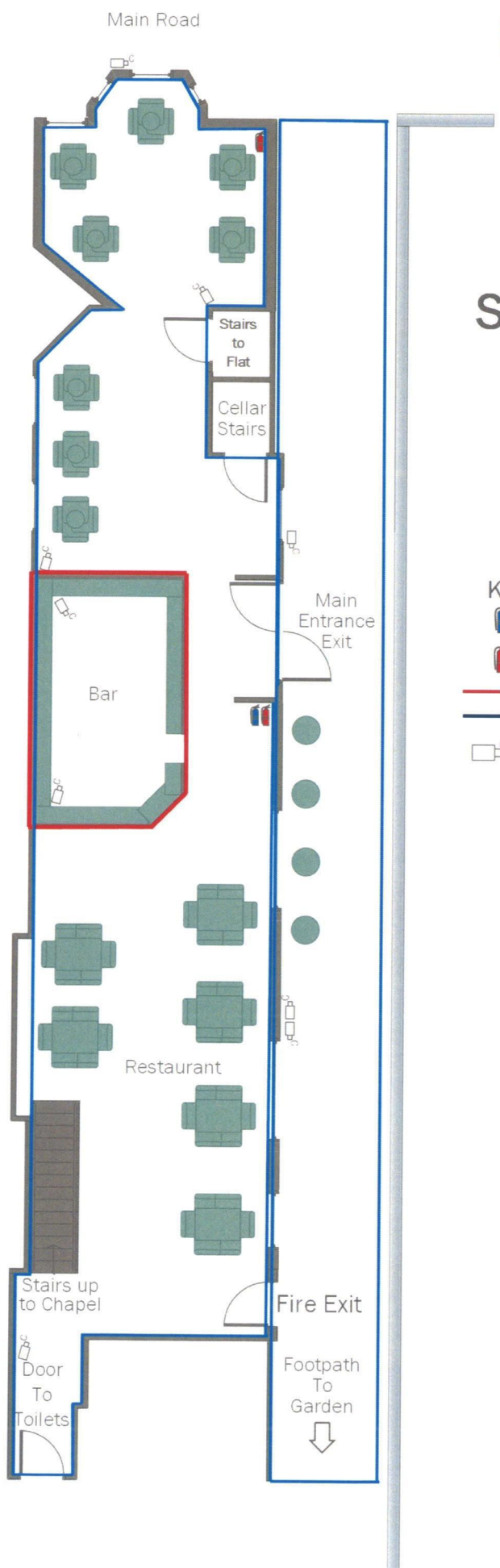

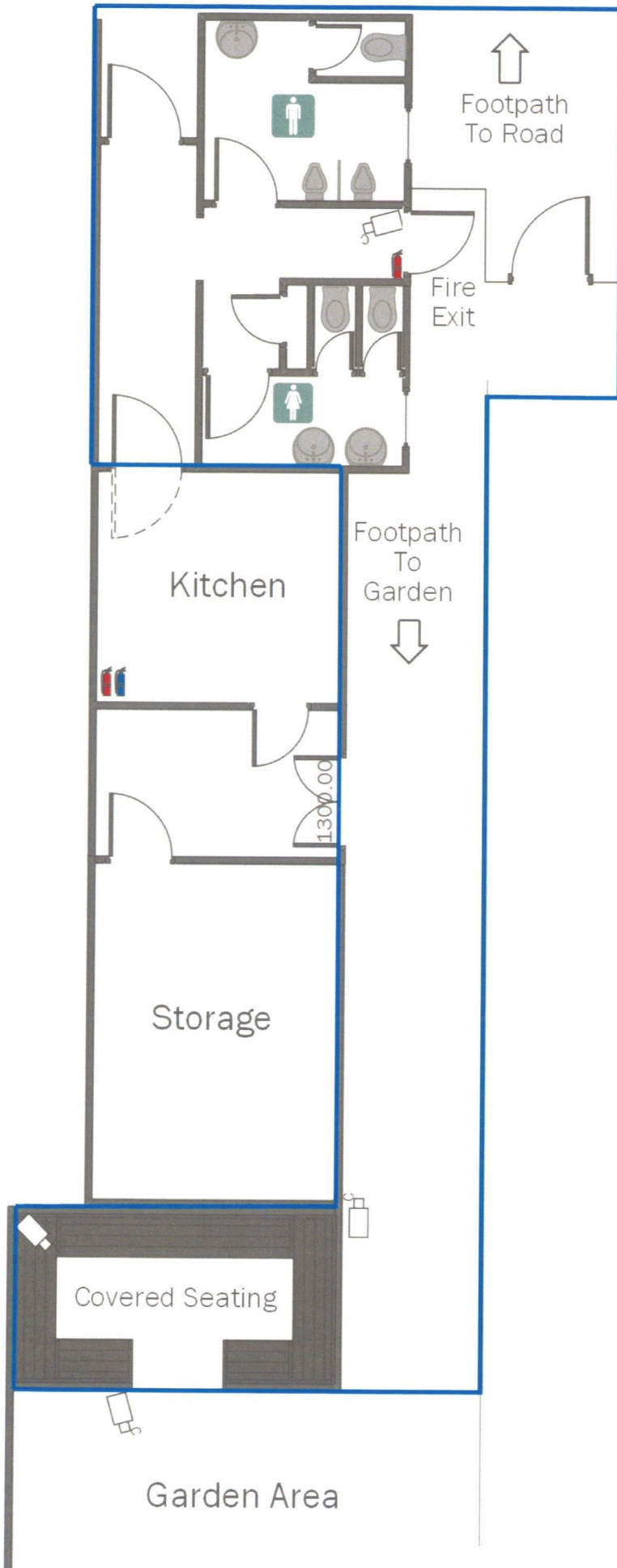

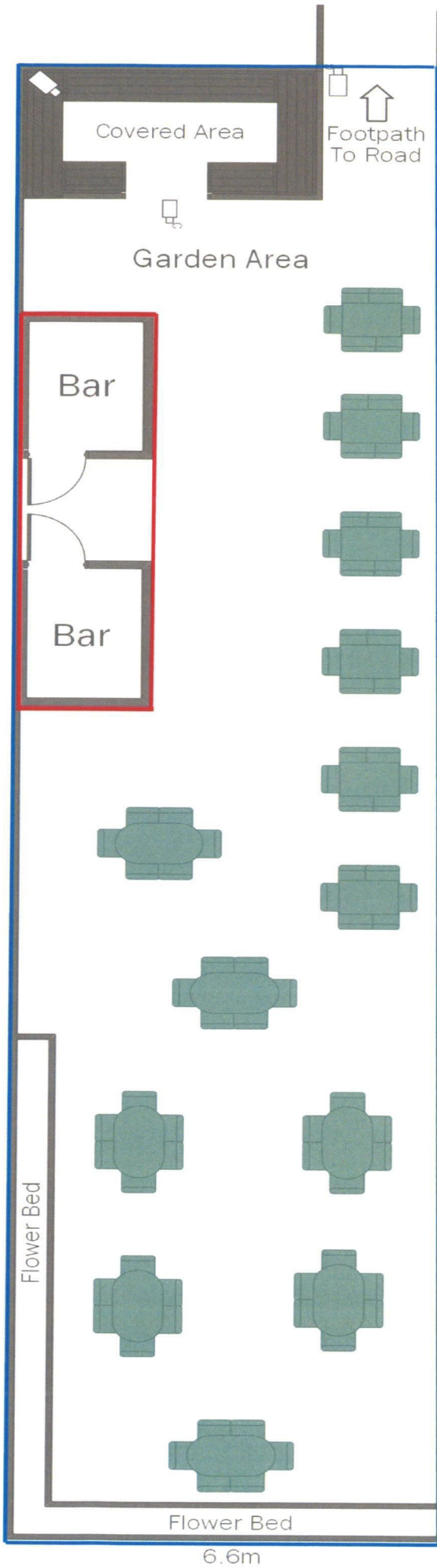

LICENSING ACT 2003



PREMISES LICENCE

PREMISES LICENCE NUMBER

WK/201203118

Part 1 – Premises Details

<p>Postal address of premises, or if none, ordnance survey map reference or description, including Post Town, Post Code</p> <p>Black Star Black Star 1 Mitton Street Stourport-On-Severn Worcestershire DY13 8YP</p>	
<p>Telephone number</p>	

<p>Where the licence is time limited, the dates</p> <p>Not applicable</p>
--

Licensable activities authorised by the licence and the times the licence authorises the carrying out of licensable activities

Activity	Days	From	To	Indoors/Outdoors
Performance of Dance	Saturday	10:00	- 00:00	Indoors
Performance of Dance	Sunday to Friday	10:00	- 23:30	Indoors
Exhibition of Films	Saturday	10:00	- 00:00	Indoors
Exhibition of Films	Sunday to Friday	10:00	- 23:30	Indoors
Indoor Sporting Events	Saturday	10:00	- 00:30	Indoors
Indoor Sporting Events	Sunday to Friday	10:00	- 00:00	Indoors
Performance of Live Music	Saturday	10:00	- 00:00	Indoors
Performance of Live Music	Sunday to Friday	10:00	- 23:30	Indoors
Late Night Refreshment	Saturday	23:00	- 00:30	Indoors
Late Night Refreshment	Sunday to Friday	23:00	- 00:00	Indoors
Playing of Recorded Music	Saturday	10:00	- 00:00	Indoors
Playing of Recorded Music	Sunday to Friday	10:00	- 23:30	Indoors
Sale of Alcohol	Saturday	10:00	- 00:30	Both
Sale of Alcohol	Sunday to Friday	10:00	- 00:00	Both

Non-standard timings

Every Friday, Saturday, Sunday and Monday of Bank Holiday weekends, Christmas Eve and Boxing Day until 00.30 hours

New Year's Eve: 10.00 until terminal hour New Year's Day

The opening hours of the premises

Days	From	To
Saturday	10:00	- 01:00
Sunday to Friday	10:00	- 00:30

Where the licence authorises supplies of alcohol whether these are on and / or off supplies

Alcohol is supplied for consumption both on and off the premises

Part 2

Name, (registered) address, telephone number and email (where relevant) of holder of premises licence

Maria & Andrew Gooding

The Black Star

1 Mitton Street

Stourport On Severn

DY13 8YP

Email Address

Telephone No.

Registered number of holder, for example company number, charity number (where applicable)

Name, address and telephone number of designated premises supervisor where the premises licence authorises for the supply of alcohol

Maria Gooding
1 Mitton Street
Stourport On Severn
Worcestershire
DY13 8YP

Personal licence number and issuing authority of personal licence held by designated premises supervisor where the premises licence authorises for the supply of alcohol

Personal Licence No: PL1263
Licensing Authority: Herefordshire Council

AUTHORISED OFFICER

Head of Regulatory Services

Worcestershire Regulatory Services

On behalf of Wyre Forest District Council

Date of first issue: 16th February 2007
This version valid from: 18th June 2019
Issuing Authority: Wyre Forest District Council
Finepoint Way
Kidderminster
DY11 7WF

ANNEX 1 – MANDATORY CONDITIONS

The making and authorisation of alcohol sales

No supply of alcohol may be made under the premises licence—

- a) at a time when there is no designated premises supervisor in respect of the premises licence, or
- b) at a time when the designated premises supervisor does not hold a personal licence or his personal licence is suspended.

Every supply of alcohol under the premises licence must be made or authorised by a person who holds a personal licence.

Irresponsible alcohol promotions

The responsible person must ensure that staff on relevant premises do not carry out, arrange or participate in any irresponsible promotions in relation to the premises.

In this paragraph, an irresponsible promotion means any one or more of the following activities, or substantially similar activities, carried on for the purpose of encouraging the sale or supply of alcohol for consumption on the premises—

- (a) games or other activities which require or encourage, or are designed to require or encourage, individuals to—
 - (i) drink a quantity of alcohol within a time limit (other than to drink alcohol sold or supplied on the premises before the cessation of the period in which the responsible person is authorised to sell or supply alcohol), or
 - (ii) drink as much alcohol as possible (whether within a time limit or otherwise);
- (b) provision of unlimited or unspecified quantities of alcohol free or for a fixed or discounted fee to the public or to a group defined by a particular characteristic in a manner which carries a significant risk of undermining a licensing objective;
- (c) provision of free or discounted alcohol or any other thing as a prize to encourage or reward the purchase and consumption of alcohol over a period of 24 hours or less in a manner which carries a significant risk of undermining a licensing objective;
- (d) selling or supplying alcohol in association with promotional posters or flyers on, or in the vicinity of, the premises which can reasonably be considered to condone, encourage or glamorise anti-social behaviour or to refer to the effects of drunkenness in any favourable manner;
- (e) dispensing alcohol directly by one person into the mouth of another (other than where that other person is unable to drink without assistance by reason of disability).

Provision of free potable water

The responsible person must ensure that free potable water is provided on request to customers where it is reasonably available.

Age verification policy for the sale or supply of alcohol

The premises licence holder or club premises certificate holder must ensure that an age verification policy is adopted in respect of the premises in relation to the sale or supply of alcohol.

The designated premises supervisor in relation to the premises licence must ensure that the supply of alcohol at the premises is carried on in accordance with the age verification policy.

The policy must require individuals who appear to the responsible person to be under 18 years of age (or such older age as may be specified in the policy) to produce on request, before being served alcohol, identification bearing their photograph, date of birth and either—

- (a) a holographic mark, or
- (b) an ultraviolet feature.

Availability of small measures of alcohol

The responsible person must ensure that—

- (a) where any of the following alcoholic drinks is sold or supplied for consumption on the premises (other than alcoholic drinks sold or supplied having been made up in advance ready for sale or supply in a securely closed container) it is available to customers in the following measures—
 - (i) beer or cider: ½ pint;
 - (ii) gin, rum, vodka or whisky: 25 ml or 35 ml; and
 - (iii) still wine in a glass: 125 ml;
- (b) these measures are displayed in a menu, price list or other printed material which is available to customers on the premises; and

- (c) where a customer does not in relation to a sale of alcohol specify the quantity of alcohol to be sold, the customer is made aware that these measures are available.

Permitted price of alcohol

- 1. A relevant person shall ensure that no alcohol is sold or supplied for consumption on or off the premises for a price which is less than the permitted price
- 2. For the purposes of the condition set out in paragraph 1—
 - a) “duty” is to be construed in accordance with the Alcoholic Liquor Duties Act 1979);
 - b) “permitted price” is the price found by applying the formula—
$$P=D+(D \times V)$$
where—
 - P is the permitted price,
 - D is the rate of duty chargeable in relation to the alcohol as if the duty were charged on the date of the sale or supply of the alcohol, and
 - V is the rate of value added tax chargeable in relation to the alcohol as if the value added tax were charged on the date of the sale or supply of the alcohol;
 - c) “relevant person” means, in relation to premises in respect of which there is in force a premises licence—
 - (i) the holder of the premises licence,
 - (ii) the designated premises supervisor (if any) in respect of such a licence, or
 - (iii) the personal licence holder who makes or authorises a supply of alcohol under such a licence;
 - d) “relevant person” means, in relation to premises in respect of which there is in force a club premises certificate, any member or officer of the club present on the premises in a capacity which enables the member or officer to prevent the supply in question; and
 - e) “valued added tax” means value added tax charged in accordance with the Value Added Tax Act 1994.
- 3. Where the permitted price given by Paragraph (b) of paragraph 2 would (apart from this paragraph) not be a whole number of pennies, the price given by that sub-paragraph shall be taken to be the price actually given by that sub-paragraph rounded up to the nearest penny.
- 4. (1) Sub-paragraph (2) applies where the permitted price given by Paragraph (b) of paragraph 2 on a day (“the first day”) would be different from the permitted price on the next day (“the second day”) as a result of a change to the rate of duty or value added tax.
(2) The permitted price which would apply on the first day applies to sales or supplies of alcohol which take place before the expiry of the period of 14 days beginning on the second day.

Admission of children to the exhibition of any film

The admission of children to the exhibition of any film is restricted by age classification awarded to the film by the British Board of Film Classification.

Where a film does not have an age classification specified by the British Board of Film Classification, admission of children must be restricted in accordance with the recommendation of the licensing authority.

“Children” means a person under the age of 18.

ANNEX 2 – CONDITIONS CONSISTENT WITH THE OPERATING SCHEDULE

a) General – all four licensing objectives (b,c,d,e):

b) The prevention of crime and disorder:

No customers apparently carrying open bottles upon entry shall be admitted to the premises at any times the premises are open to the public.

Where CCTV is installed with recording facilities such recordings shall be retained for a period of 30 days and made available within reasonable time upon request by the Police.

Alcoholic and other drinks may not be removed from the premises in open containers save for consumption in any external area provided for that purpose.

c) Public safety:

To comply with the reasonable requirements of the fire officer.

To comply with the reasonable requirements of the building control officer..

d) The prevention of public nuisance:

Where appropriate, prominent, clear and legible notices shall be displayed at all exits requesting the public respect the needs of local residents and they leave the premises and area quietly.

Noise or vibration shall not emanate from the premises so as to cause a nuisance to nearby properties.

e) The protection of children from harm:

Children under the age of 16 years shall not be permitted to enter the premises after 21:00hrs.

Other operating conditions

**ANNEX 3 – CONDITIONS ATTACHED AFTER A HEARING BY THE LICENSING
AUTHORITY**

ANNEX 4 – PLANS

As deposited with the licensing authority

WORCESTERSHIRE REGULATORY
SERVICES

15 MAY 2020

MITTON LODGE
VALE ROAD
STOURPORT-ON-SEVER

DY13 8

14.5.2020.

Dear Sir,

I wish to strongly object to the suggested increase in hours of opening at the BLACK STAR in Stourport on planning application 20/01971/VARY PL.

The situation of the hours they are allowed to open now are bad enough with excessive noise from bands and people shouting and singing in the garden area late at night with extra hours this will spill into early morning.

Please remember we are a retirement complex and have residents who like me are only metres away from the boundary line and some are in their 90's and wish not to listen to this chaos.

So consider our feelings as we would

like to spend the remainder of our
life span in peace and tranquillity.

Yours Sincerely



WORCESTERSHIRE REGULATORY
SERVICES
15 MAY 2020

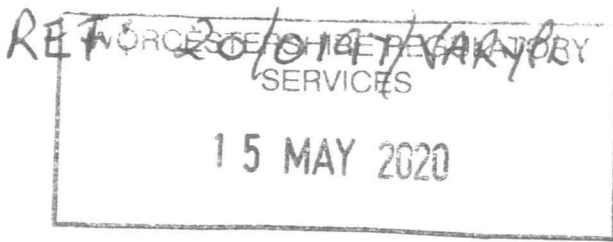

Mrs. P. Banks
 [REDACTED], Milton Lodge
 Vale Rd.
 Stourport-on-Severn
 DY13 8 [REDACTED]

Dear Sirs,

With reference to the application 20/01971/VARYPL made by Maria + Andrew Gooding to extend their business hours at week-ends + "Special Events" until the early hours of the morning at the "Black Star" at 1, Milton St, Stourport-on-Severn DY13 8YP.

I would like to register my strong objections to any extension which would affect the 'Health + Safety' of the owner/occupiers of the adjacent address, Milton Lodge DY13

The "Noise Nuisance" issuing from that establishment already causes stress + distress to elderly + sick people living next to the business which did not exist when

2

REF: 20/0197/VARYAL

first these flats were purchased in 2012,
+ were marketed in good faith to the over 60's
an extension of the noise + the lateness of
hours, + the volume of noise would have a
grave detrimental affect on the health —
both mental + physical on these senior
citizens ~~wh~~ who now need + deserve peace + quiet.

I beg of you, on the grounds of "Health +
Safety" + "Community Protection (Noise nuisance)"
not to grant permission for their requested
extension of hours + "Additional Events".

yours sincerely,

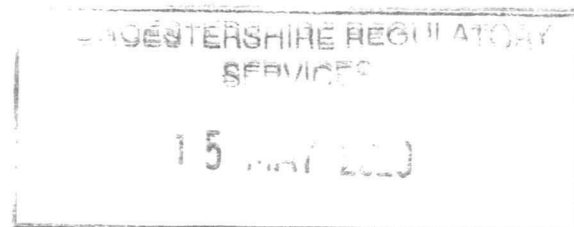

LM Mitton

From: Mike Perrins [REDACTED]
Sent: 14 May 2020 13:38
To: [REDACTED]
Subject: Black Star

WORCESTERSHIRE REGULATORY SERVICES
15 MAY 2020

To Whom It May Concern.ref 20/01971/VARYPL.

We are writing to complain about the request for extended Licensing hours at the Black Star public house Stourport on Severn..

We have an apartment in the complex next to this venue it consists of over 60ys several in their eighties and some in their nineties.

While we accept a certain amount of noise as it is a public house. Last year we had to complain twice about the noise of the music especially outside, it was so loud we couldn't sit in our garden and when indoors had to close the windows and turn up the T.V. We could still hear the noise. We have learned to live with this during the summer, but the thought that it could go on until 1am on some days and twelve on the others fills us with horror.

This means that with regular occurrence we will have music every night some till midnight others until 1am. On top of that sporting events at any hour.

We reiterate we have already had to complain about the noise twice when they were tenants the first time we had a letter apologising and was assured it was a one off, the second complaint after they had bought the pub the letter was not acknowledged at all.

[REDACTED] is within about four feet of the pub garden along with several others, some peoples lounges are around six feet away.

Might I suggest someone actually comes to see how close we are to this noise before any thing is passed.

Yours faithfully

[REDACTED SIGNATURE]

Mr+ Mrs. M. Perrins,
[REDACTED] Milton Lodge,
Vale Road,
S.O.S.
WORCS. DY13 8 [REDACTED]

18 MAY 2020

Mettons Lodge
 Vale Road
 Stourport-on-Severn
 DY13 8

To whom it may concern -

Ref Black Star Planning Number
 20/01971/VARYPL

This planning is to extend
 opening: SUN/MON/TUE/WED/THURS - 00.00 hrs
 FRI/SAT - 1.00 hrs
 BANK HOLIDAYS FRI/SAT/SUN/MON - 1.00 hrs
 CHRISTMAS EVE - 1.00 hrs
 BOXING DAY - 1.00 hrs
 LIVE OUTSIDE Music - 9.00 hrs

As this fair Drinks could
 be served till almost
 closing time. It could be

1.30 hrs by the time everyone has left. All in high spirits (I don't blame them) many walk home along the canal, some singing, all jolly chatting, but not appreciated by me or any other tenants of Mellars Lodge, Jean 92, Mily 91, Tom 94 myself 84.

I have been here since December and The Black Star has music nights Friday, Saturday and Sunday, but they finish at 11.00 by the time everyone has passed for home its 11.30 - 12.00. I have coped with this. Closing my windows has been a huge help.

But I have not faced
 a summer with the
 windows open. I can still
 cope with this, but these
 new hours is not fair.
 The music now is just a
 loud, loud repeat of notes,
 the louder the better
 I am sorry but I hope
 these new hours will
 not be passed.

The Black Star is a small
 pub not a Hall, Concert Room
 or large building to take this
 type of noise. During the
 week I with families and
 children to get to bed
 I think pubs should be
 closed at a considerate time



From: Charles Glen
Sent: 19 May 2020 15:18
To: WRS Enquiries
Subject: External Email : Application to Vary a Premises Licence: Maria and Andrew Gooding, Black Star, Stourport

This email originated from outside of the organisation

STOP : Were you expecting this email? Does it look genuine?

THINK : Before you CLICK on any links or OPEN any attachments.

Dear Sir/Madam

In July of 2015 my wife and I relocated from our home town in [REDACTED] to be nearer to our family and decided to move to a Churchill Retirement Development as we wanted this to be our last move. We chose Stourport-on-Severn as we believed it to be a suitable place to spend our retirement. In many ways we were not wrong: Stourport has much to recommend it. We opted to live in Mitton Lodge, Vale Road - with its canal-side location and proximity to local shops it is ideal.

However, as always in life not everything is totally satisfactory! We had to learn to live with the noisy Stourport Pizza and Kebab business across the canal in Lombard Street. Delivery cars come and go every evening, and as late as 3.00 pm at weekends. Thoughtlessly the drivers sometimes sit waiting for deliveries with car engines running, radios pumping out music and having loud conversations with each other oblivious to the fact that their neighbours are trying to sleep. We then have the clattering and clanging of bins being emptied and trays being power-hosed in the early hours of the morning.

Last year The Lounge in Lombard Street was given a licence to remain open until 2.00 am playing music. On a warm summer's evening, aided by the canal waters, we are treated to all kinds of music whether we like it or not.

Notwithstanding all of the aforementioned difficulties, by far the most disturbing aspect of life at Mitton Lodge has been the Black Star. When we first moved here the Black Star was a pleasant canal-side pub serving good food - in fact we often went there for Sunday lunch. All this changed however when they introduced their programme of Live Music. Please don't misunderstand: my wife and I are music lovers - we have all kinds of different music playing in our apartment every day. However, every weekend we have to endure the sound of live music of varying quality. Very often it is so loud we aren't able to hear our own television in our own lounge. This goes on for hours at a time and is very disturbing, but we managed to somehow hang on till midnight when we knew the music would end and we could finally get to sleep (though this is usually followed by a further hour of shouting, fighting and caterwauling as the revellers make their way home). Some of our neighbours have tried writing to the Goodings to let them know how unacceptable this is, but I'm afraid it has made no difference.

Imagine how we felt when we heard that the Black Star proprietors have applied for an extension to their licence so they can stay open until 1.00 pm at weekends and play live music most evenings until 9.00 pm! This will make life here at Mitton Lodge unbearable for its many older apartment owners. We know many of our neighbours get extremely distressed

by the loud music and how much it intrudes into their apartments. (I think the performers forget that it is only a tiny pub and not The Royal Albert Hall and don't set their amplifiers accordingly!)

The peaceful, pleasant retirement planned after a busy life raising a family and running a demanding business seems to be evaporating before our eyes. Please, we beg you, do not grant this request for a Licence Extension for this business: I have no doubt that it will continue to make substantial profits without it. Please don't allow them to ride roughshod over peaceful, retired individuals who just want to co-exist peacefully - many of whom are in their 80s and 90s and don't deserve their final years to be marred by this.

We have come to love Stourport and view it as our home. We realise that give and take is needed in life, and we're prepared to accept that a lot of things which we don't like are enjoyed by other people. However, we have to draw the line at loud music being played until 1.00 am under our window. Even tolerance has its limits.

Yours faithfully

Charles & Miriam Glen

From: Miriam Glen
Sent: 19 May 2020 16:14
To: WRS Enquiries
Subject: External Email : Application to Vary a Premises Licence: Black Star, Stourport

This email originated from outside of the organisation

STOP : Were you expecting this email? Does it look genuine?

THINK : Before you **CLICK** on any links or **OPEN** any attachments.

I am sending this letter on behalf of my neighbour, Tom Williams:

Mr T Williams
■ Mitton Lodge
Vale Road
STOURPORT-ON-SEVERN
DY13 8■

Licensing
Worcester Regulatory Service
Wyre Forest House
Finepoint Way
KIDDERMINSTER
DY11 7WF

Dear Sir or Madam

Re: APPLICATION TO VARY A PREMISES LICENCE, BLACK STAR, STOURPORT

I wish to object strongly to the granting of an extended licence to the Black Star, Mitton Street, Stourport.

I am 90 years old and live in an ■ apartment in Mitton Lodge ■ the Black Star gardens. I chose to live my final years here because it was such a peaceful spot along the side of the canal.

However, my quality of life has been greatly affected by the loud music played by the Black Star, particularly in the summer when they allow outside performances. Even when the performers are inside the pub it is still very loud in the summer as the windows are open, but when they are outside it is unbearably loud.

My bedroom is [REDACTED] to the Beer Garden, and I am kept awake at the weekends by the loud music that seems as if it is in my room. If they are allowed to stay open another hour I would find it very distressing. I know my neighbours feel the same way.

Yours faithfully
Tom Williams